



EDNAKE SMART HOME SOLUTION

DNAKE (Xiamen) Intelligent Technology Co., Ltd.

CONTENTS

01

**GENERAL
OVERVIEW**

02

**SMART
PANEL**

03

**SMART
SWITCH**

04

**SECURITY
SENSOR**

05

**CURTAIN
MOTOR**

01

GENERAL OVERVIEW

www.dnake-global.com

Smart Switch
Switch on/off light



Control Panel
IR device control



Smart Scene Switch
Personalized scene control



Curtain Motor
Control open/close of curtain



Smart Dimmer Switch
Switch and adjust brightness of lighting

Water Leak Sensor

Smoke Sensor

Gateway

Motion Sensor

Temperature&humidity Sensor



Curtain Switch
Control open/close of curtain

Door Sensor

Control Center
Control all connected smart devices of house



Control Panel
Voice control, scene control





All-in-One Smart Living Solution

DNAKE



One Panel, One App

- Video intercom + whole-home smart control in one system for a seamless living experience.



Voice Control Ready

- Works with Siri and Alexa. Use natural voice commands to control lights, curtains, AC, and more.



Custom Smart Scenes

- Set up personalized modes like “Home”, “Away”, or “Sleep” to automate multiple devices in one tap.



Remote Access Anywhere

- Control devices, check status, talk to visitors, and unlock doors anytime via mobile app.



Offline Local Control

- Stay connected even without internet. Supports stable LAN-based local control.



VILLA SOLUTION

DNAKE

UTP ———
WIFI - - - -
Zigbee - - - -

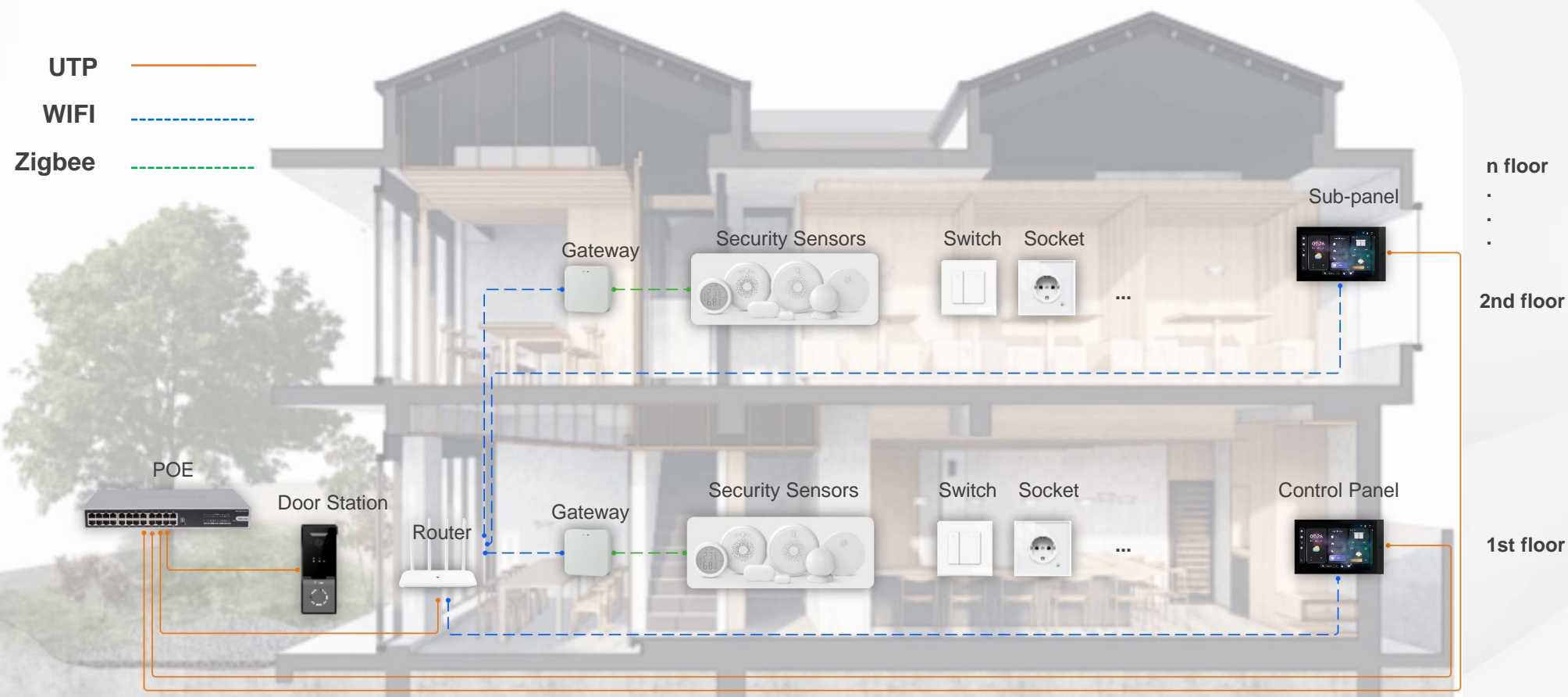



APARTMENT SOLUTION

DNAKE

UTP ———
Wifi - - - -
Zigbee - - - -
RS485 ———





SMART HOME & INTERCOM TWO IN ONE

DNAKE

Smart Home Ecoproducts



1-gang Switch



2-gang Switch



3-gang Switch



Dimmer Switch



Curtain Switch



4 Scene Switch



Curtain Motor



Tubular Motor



Gas Sensor



Smoke Sensor



Water Leak Sensor



Smart Button



Motion Sensor



Door&Window sensor



Temperature&Humidity Sensor



Smart Intercom



10-inch control panel



4-inch control panel



3.5-inch control panel



8-inch control panel



Zigbee&Bluetooth Hub

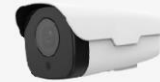



ALL IN ONE CONTROL

DNAKE

Everything can be easily controlled on one app and smart panel.

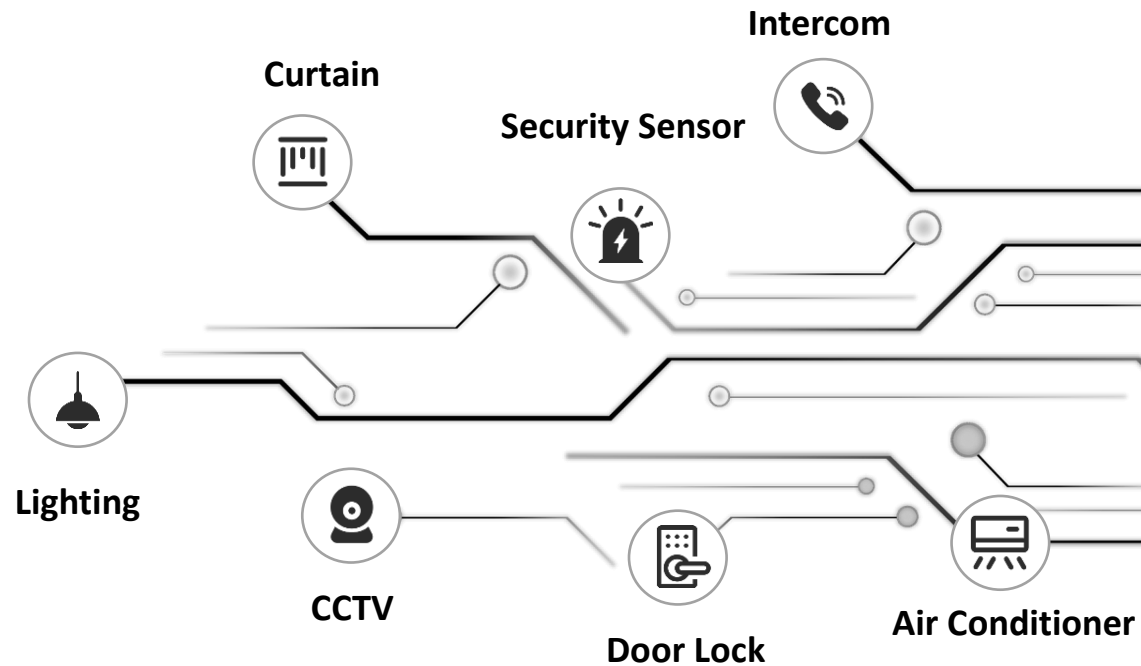



SMART VOICE CONTROL

DNAKE

Works with **Alexa & Siri** voice service of control smart devices, trigger scenes etc.
Enjoy the convenience of voice control with audio and visual responses.



Hey, Siri...

Light up the living room,

I'm home now



😊 Set the room temperature to 23°C.

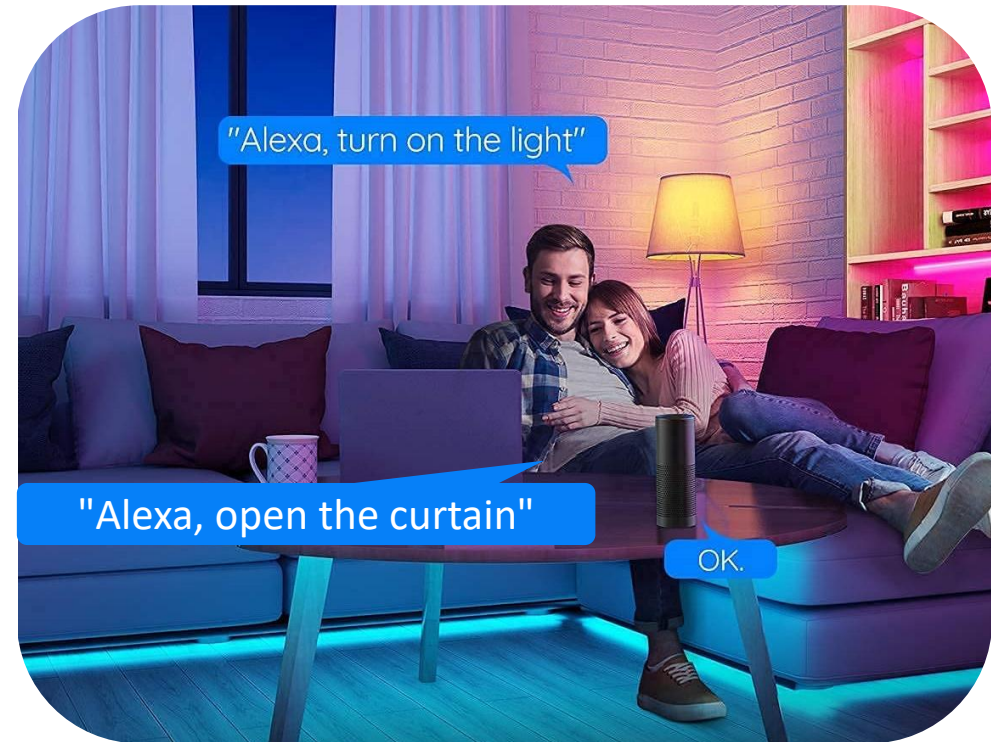

02

SMART PANEL

www.dnake-global.com



PRODUCT OVERVIEW

D-NAKE



3.5"



4"



8"



10"

3.5" Linux Smart Control Panel

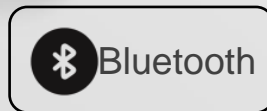
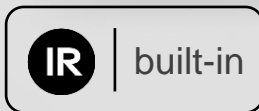

3.5-inch 480*320 IPS Touch Screen



3 Physical Buttons for 3 Relays Control



Built-in BLE Mesh Gateway
Support 128 Sub-devices



Built-in IR, Support 12 Categories of IR Device Control

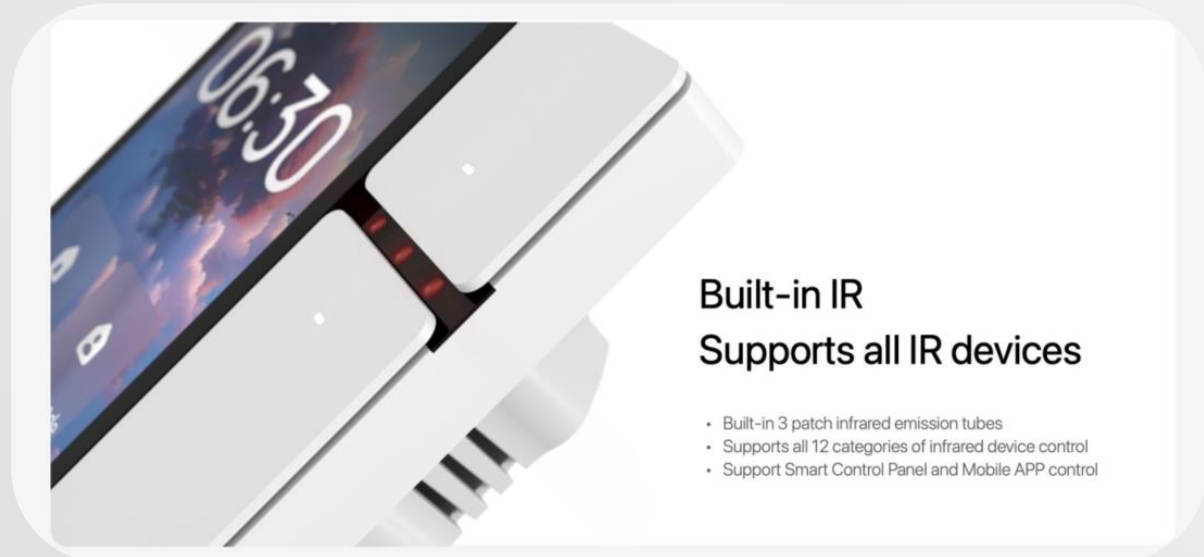

Built-in IR
Supports all IR devices

- Built-in 3 patch infrared emission tubes
- Supports all 12 categories of infrared device control
- Support Smart Control Panel and Mobile APP control

ADD INFRARED DEVICE ON DNAKE SMART LIFE APP

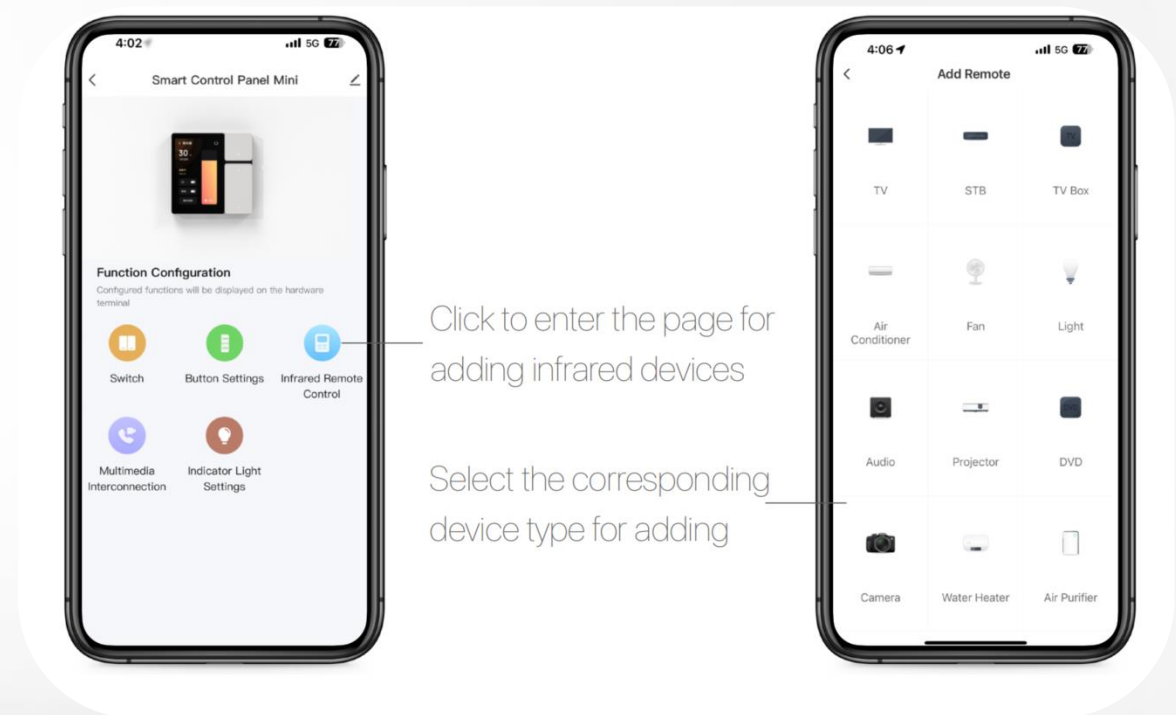
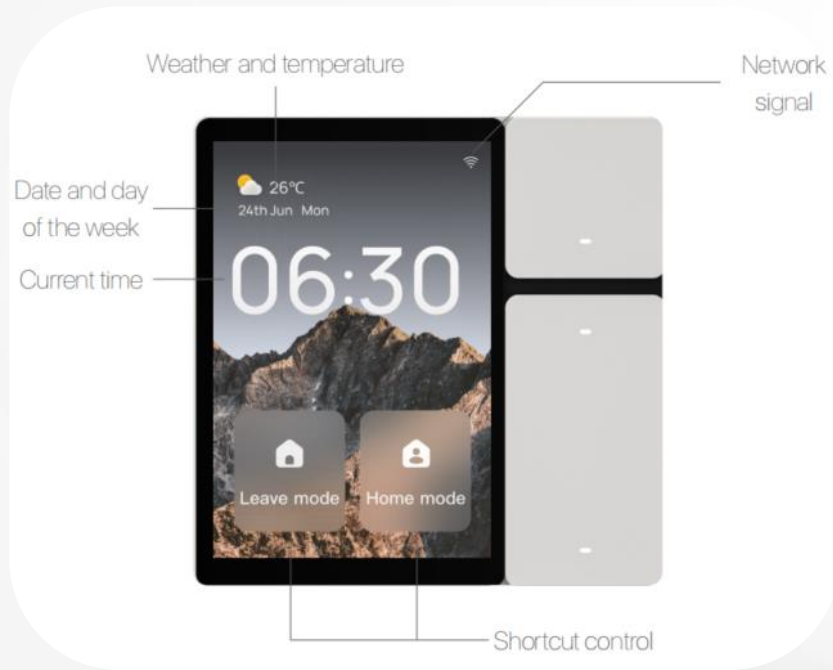

3 PHYSICAL BUTTONS FOR 3 RELAYS CONTROL

Unique
button design
Asymmetrical
aesthetics



L1
L2
L3



Neutral wire

Live wire

User-defined
button

Device, Scenes, Video



BUILT-IN BLE MESH GATEWAY

Support Stable Operation of 128 SigMesh Sub-devices



SECURITY ALARM

If a danger is detected, the alarm will be given immediately.



SOS Alarm



Smoke Alarm



Gas Alarm



Water Leakage Alarm

4" Linux Smart Control Panel

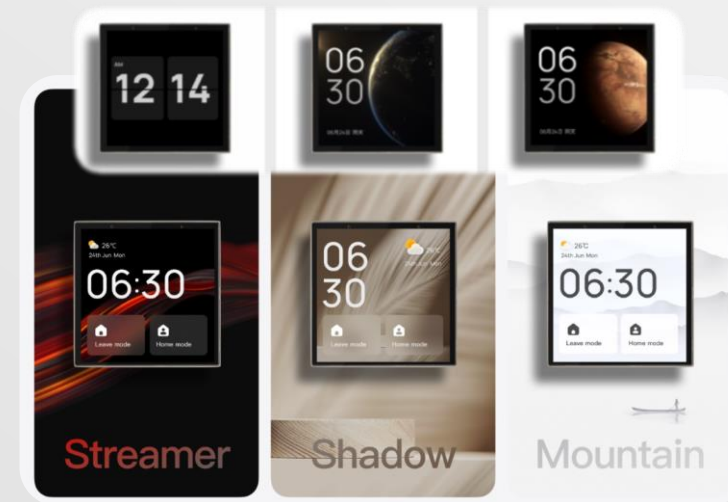
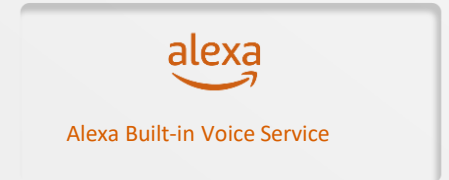
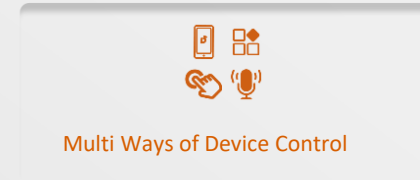
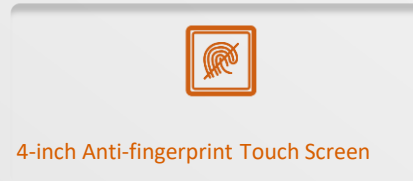
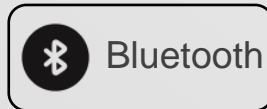
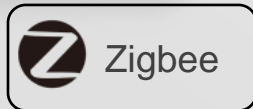
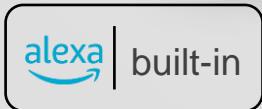

Multiple sets of themes and Screensavers

All in one One is all



Gateway



Smart Doorbell



Light Control



Air conditioner Panel



Switch Panel



Curtain switch

Home Page

Home page customized for family scenes supports multiple wallpaper modes, the information is clear, and the operation can be achieved in one step.

Exquisite theme

Support multiple sets of different beautiful themes, users can choose freely

Date and time

Clear at a glance, real-time display of time, date and other information

Shortcut

Support to fix common devices and common scenes to home page, which is convenient to control



Weather information

Automatically display weather conditions outside

Smart switching

Minimalist interaction, swipe left for device control, swipe right for one-click scenarios, and swipe up for common operations

Zigbee Gateway

- Built-in Zigbee gateway, support 100+ sub-devices to access the network, remote OTA upgrade
- Support cross-protocol and cross-gateway local linkage



Alexa Voice Service

Alexa Built-in

Put Amazon Alexa in your walls and enjoy the convenience of built-in clutter-free voice control with audio and visual responses from a touchscreen panel on your wall.

Thanks to Alexa built-in, Smart Control Panel can realize voice control of IoT devices, trigger scenes, set alarm clocks, weather forecasts, traffic broadcasts, etc.



LOCAL CONTROL

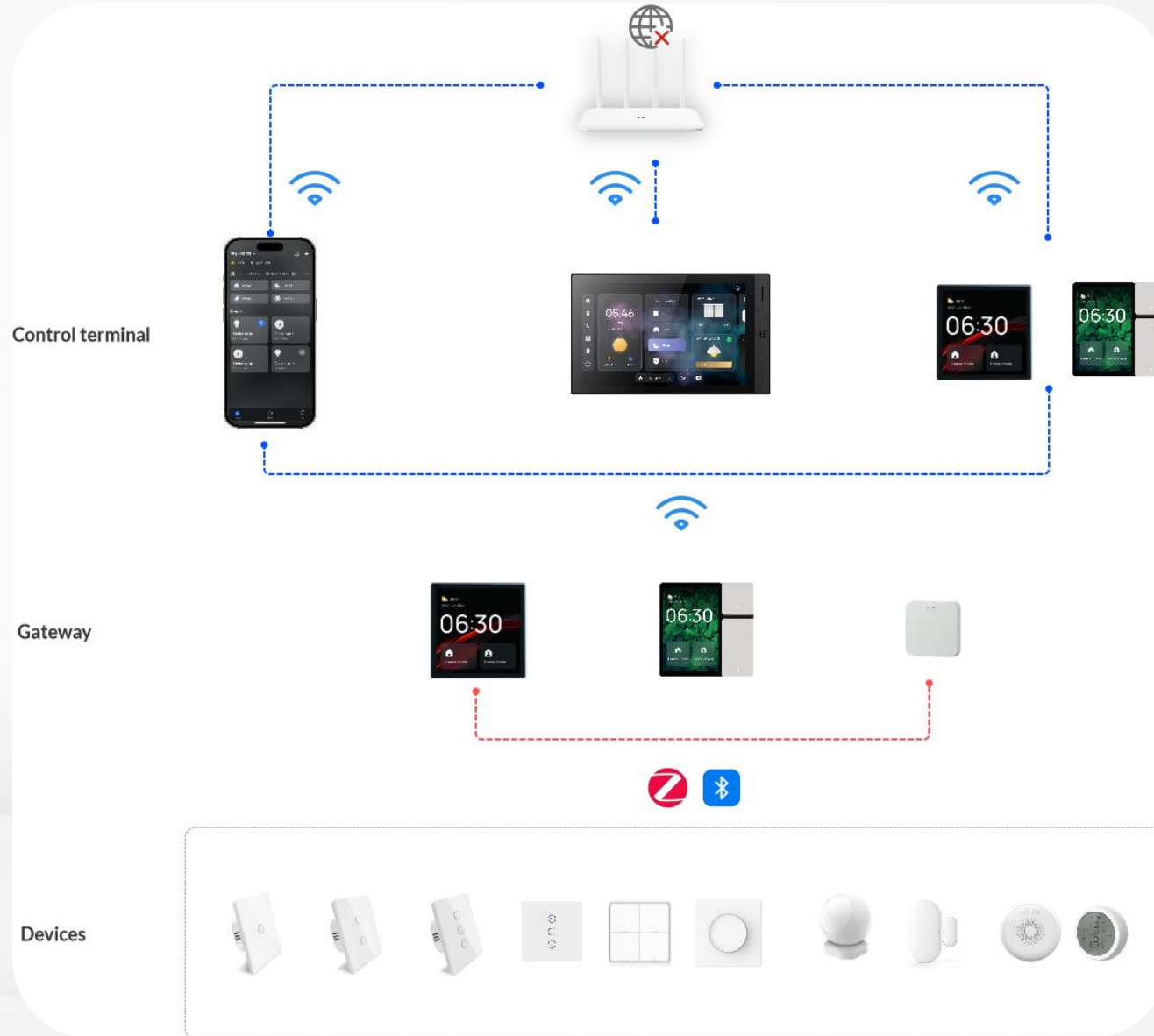



PRODUCT COMPARISON

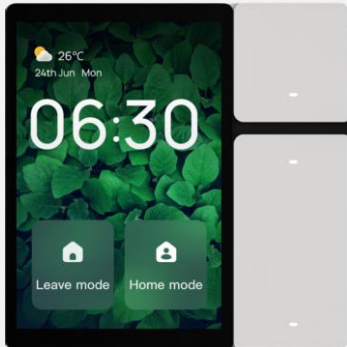

Items	4" Linux Smart Control Panel	3.5" Linux Smart Control Panel
Appearance		
Screen	4"	3.5"
Gateway	Zigbee, BLE Mesh	BLE Mesh
Relay	/	3
IR Device Control	/	Support
Voice Control	Built-in Alexa	Works with Alexa
Sales Region	EU, ME, APAC	

H618 10.1" Android Smart Control Panel



Aluminum Front Panel



IPS Capacitive Touchscreen
with 1280 x 800 Resolution



Optional 2MP Camera



Optional Wi-Fi



Video Intercom &
CCTV Integration



Easy Integration with
ZigBee Gateway



Configurable Homepage Menu and
Scenes



Max 9 Panels Extension
in One Home



H616 8" Android Smart Control Panel



Aluminum Front Panel



IPS Capacitive Touchscreen
with 1280 x 800 Resolution



TF Card Supported



Optional Wi-Fi



Video Intercom &
CCTV Integration



Easy Integration with
ZigBee Gateway



Configurable Homepage Menu
and Scenes



Max 9 Panels Extension
in One Home



CARD DESIGN SHORTCUT FUNCTION

Customize Your Favorite Desktop



SET UP SCENE CONTROL

Make A Smarter, Easier Life

Light Mode



eg, When the sensor detects human motion, it will automatically switch the light.

Wake Up Mode

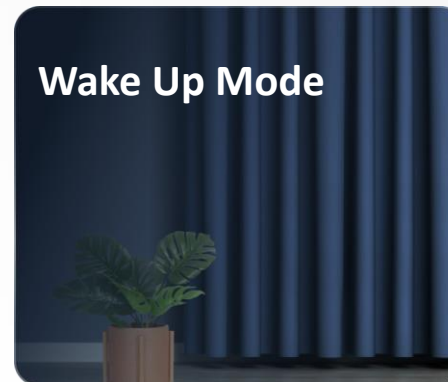

eg, At wake up time, the curtain will automatically open and the clock will go off.

Sleep Mode

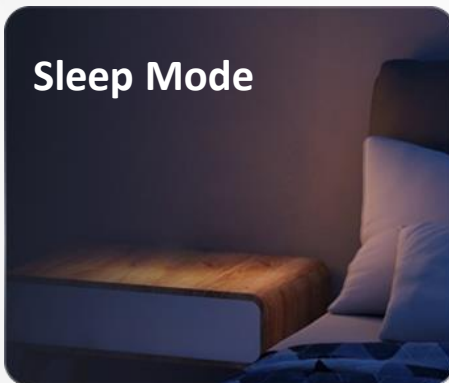

eg, When user wants to get sleep, just tap one button on mobile app to turn everything off.

Leave Mode

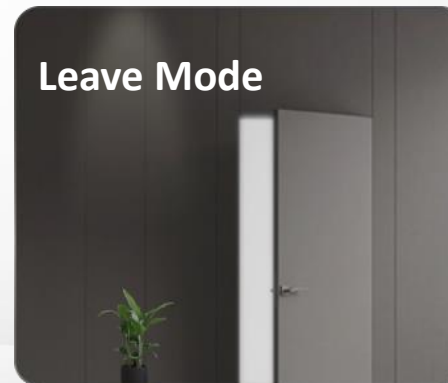

eg, When user leaves home and door status changed, all electrical will automatically shut down.

24/7 SAFEGUARD YOUR HOME



Community master station will immediately receive alarms once any potential dangers detected from your house.



INTERCOM & DOOR CONTROL

Provides high-definition audio and video communication with door station and room-to-room communication via SIP 2.0 protocol.

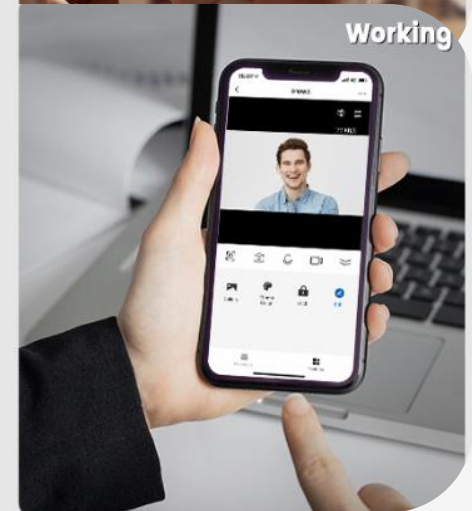
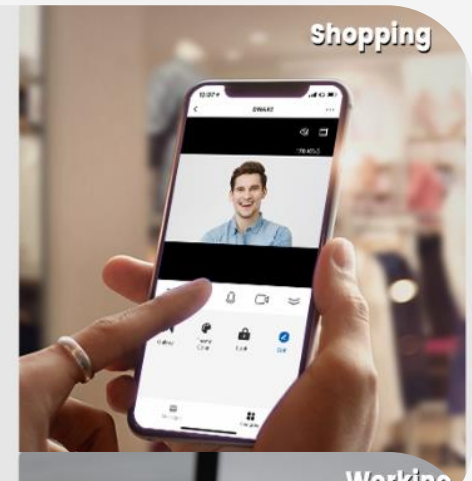
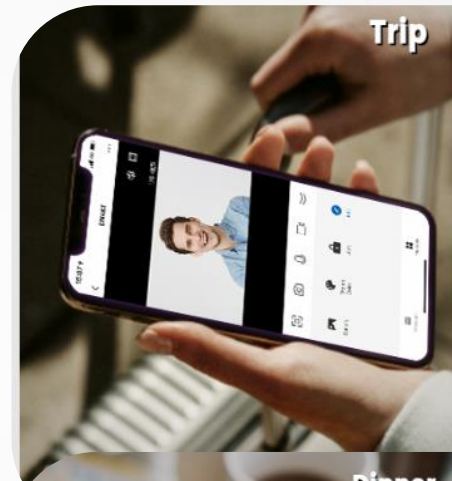

03

SMART SWITCH

www.dnake-global.com





Light Switch



Curtain Switch

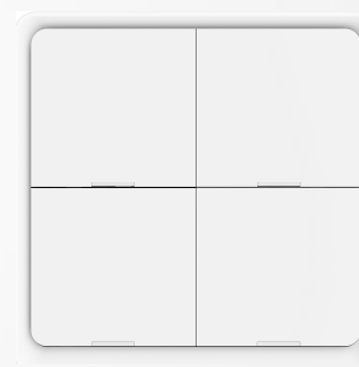

Scene Switch



Dimmer Switch

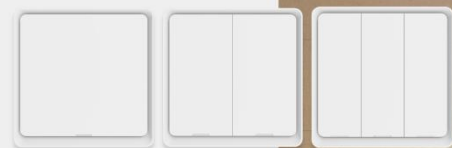

Smart Light Switch



Light up your smart life anytime, anywhere

APPLICATION SCENARIOS

Remote control

By using the APP you can turn on the curtains even when you are not home.

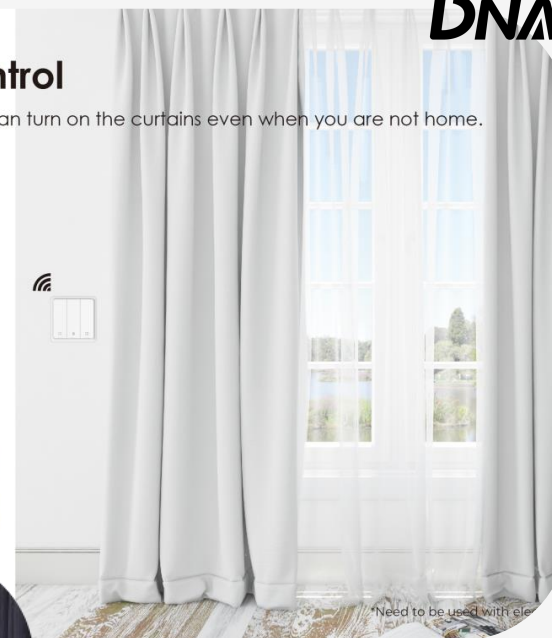
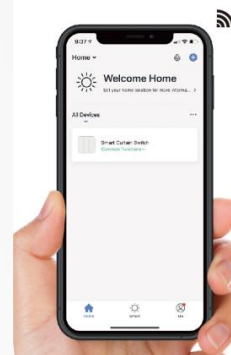

3 Operation setting 12 Scene setting



Single Press



Dual Press



Long Press

Rotate Diming

Rotate the button left and right to adjust the light level



Smart Light Switch (EU)



APP Remote Control



Hands-free Voice Control



Group Control



Automatically Turn on /off the
Lights on Time



Support Multi-Panel to
Control 1 Light



3 kinds of Restart State

- Operating Voltage: AC100V-240V/50Hz~60Hz
- Wireless Protocol: Zigbee 3.0
- Control Channel: 1/2/3 CH
- Material: Fireproof PC
- Dimension: 86*86*37.5mm
- Work with Alexa

Smart Dimmer Switch (EU)

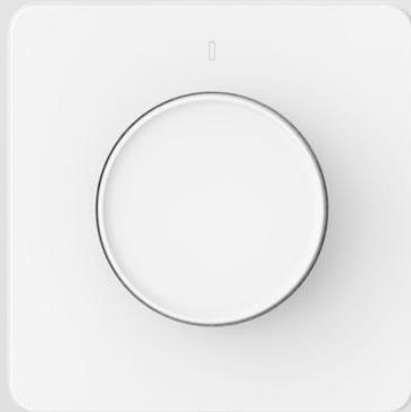

APP Remote Control



Hands-free Voice Control



Group control



Stepless Rotate Control



Mechanical On/Off Switch

- Operating Voltage: AC100V-240V/50Hz~60Hz
- Wireless Protocol: Zigbee3.0
- Control Channel: 1 CH
- Dimension: 86*86*53.5mm
- Working Temperature: -10°C~45°C
- Working Humidity: < 90%RH
- Work with Alexa

Smart Scene Switch

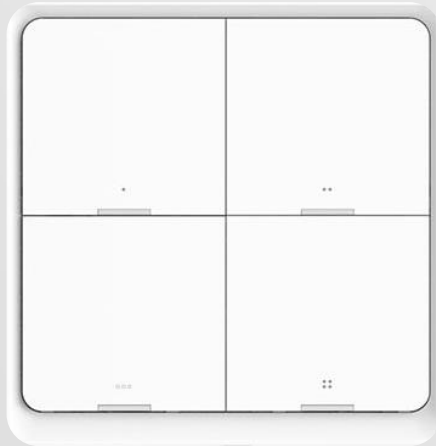

Switch with Double-Sided Tape,
Easy to Fix It on Anywhere



3 Select Conditions for Each Button to Excute Various
Scene on One Button



Mechanical Button



Control Lights, Electronics and Small
Appliances from Anywhere

- Input Power: CR2430 Button cell
- Wireless Protocol: Zigbee3.0
- Dimension: 86*86mm
- Working Temperature: -10°C~45°C
- Working Humidity: < 90%RH
- Work with Alexa

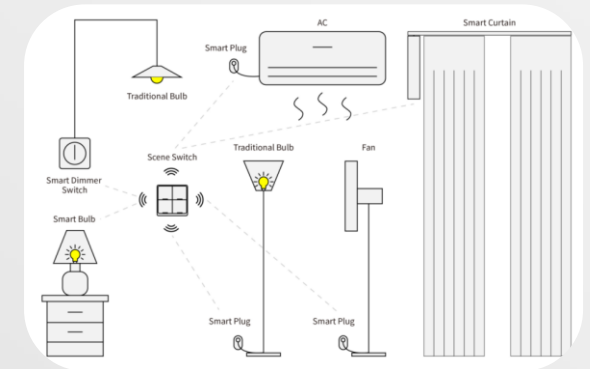

Smart Curtain Switch (EU)



APP Remote Control



Hands-free Voice Control



Group & Scene Control



Open and Close Curtains
at a Preset Time

- Operating Voltage: AC100V-240V/50Hz~60Hz.
- Wireless Protocol: Zigbee3.0
- Control Channel: 1 CH
- Dimension: 86*86*37.5mm
- Working Temperature: -10°C~50°C
- Working Humidity: < 90%
- Work with Alexa

04

SECURITY SENSOR

www.dnake-global.com





PRODUCT OVERVIEW



Water Leak Sensor



Gas Sensor



Smoke Sensor



Smart Button



Temperature and
Humidity Sensor



Motion Sensor



Door/Window Sensor

Gas Sensor



Aging and rupture of gas pipelines



Forgot to close the gas switch



Gas leakage from water heater



Forgot to close the gas valve

Wireless Technology	ZigBee
Transmission Frequency	2.4 GHz
Working Voltage	AC220V
Standby Current	≤ 200 mA
Operating Environment	0°C to +55°C $\leq 95\%$ RH
Detected Gas	Methane (Natural gas)
Alarm LEL	8% LEL Methane (Natural gas)
Concentration Error	$\pm 3\%$ LEL
Alarm Method	Audible and visual alarm, and wireless connection alarm
Alarm Sound Pressure	≥ 70 dB (1 m in front of the gas detector)
Installation Method	Wall-mounting or ceiling-mounting
Dimensions	$\phi 85$ mm x 30 mm

Smoke Sensor

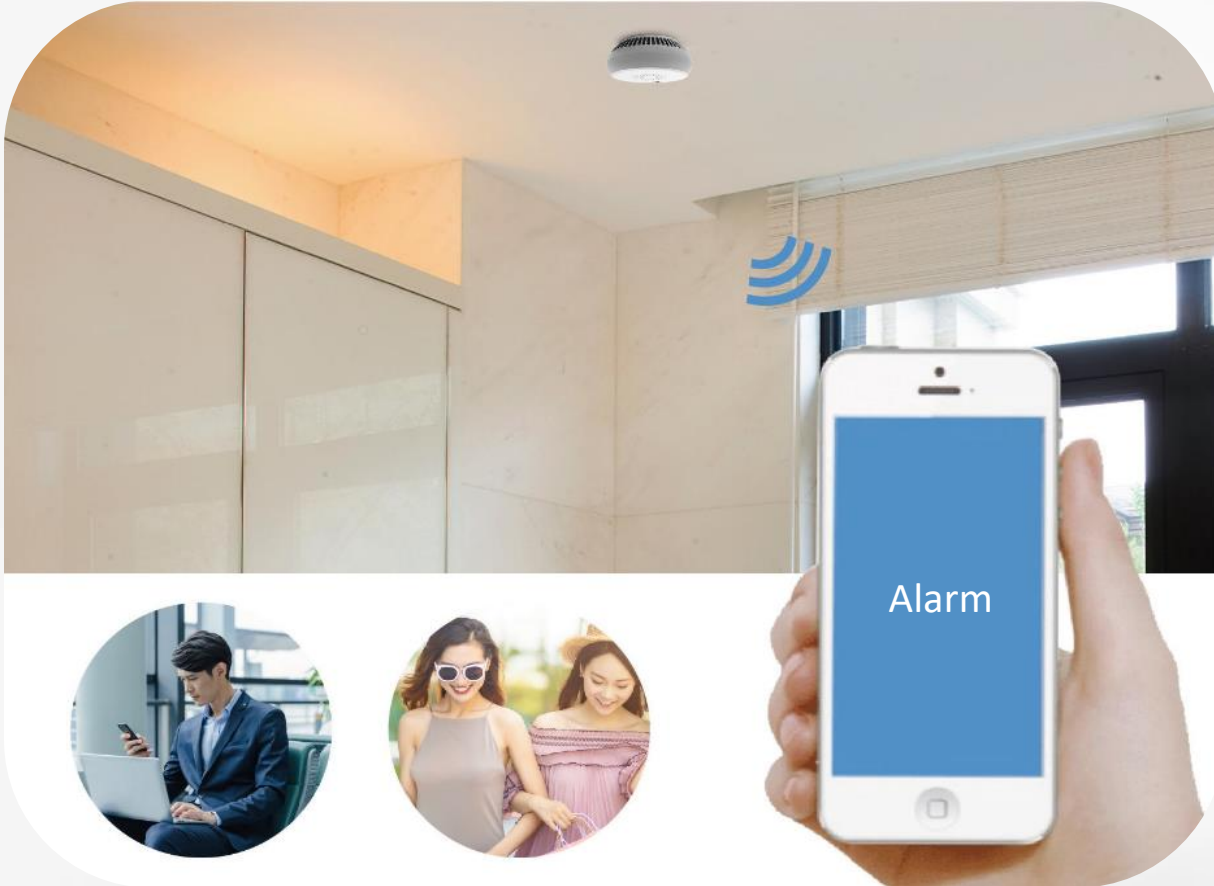

Electrical aging
causing fires



Forgot to close the gas
switch



Unaware fire when
leaving home

Wireless Technology	ZigBee
Transmission Frequency	2.4 GHz
Working Voltage	DC 3 V (CR123A battery)
Undervoltage Alarm	Supported
Working Temperature	-10°C to +55°C
Detector Type	Independent smoke detector
Alarm Sound Pressure	≥ 80 dB (3 m in front of the smoke detector)
Installation Position	Ceiling
Battery Lifespan	More than three years (20 times/day)
Dimensions	Φ90 mm x 37 mm



Motion Sensor



Motion Sensor

+

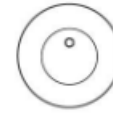

Gateway

+



Lighting



Motion Sensor

+

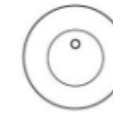

Gateway

+



APP

Wireless Technology	ZigBee
Working Voltage	DC 3 V (CR123A battery)
Transmission Frequency	2.4 GHz
Working Temperature	-10°C to +55°C
Undervoltage Alarm	Supported
Detection Radius	8 m
Detection Angle	90°
Installation Height	2.2 m
Dimensions	48.4 mm x 53.4 mm

Temperature and Humidity Sensor

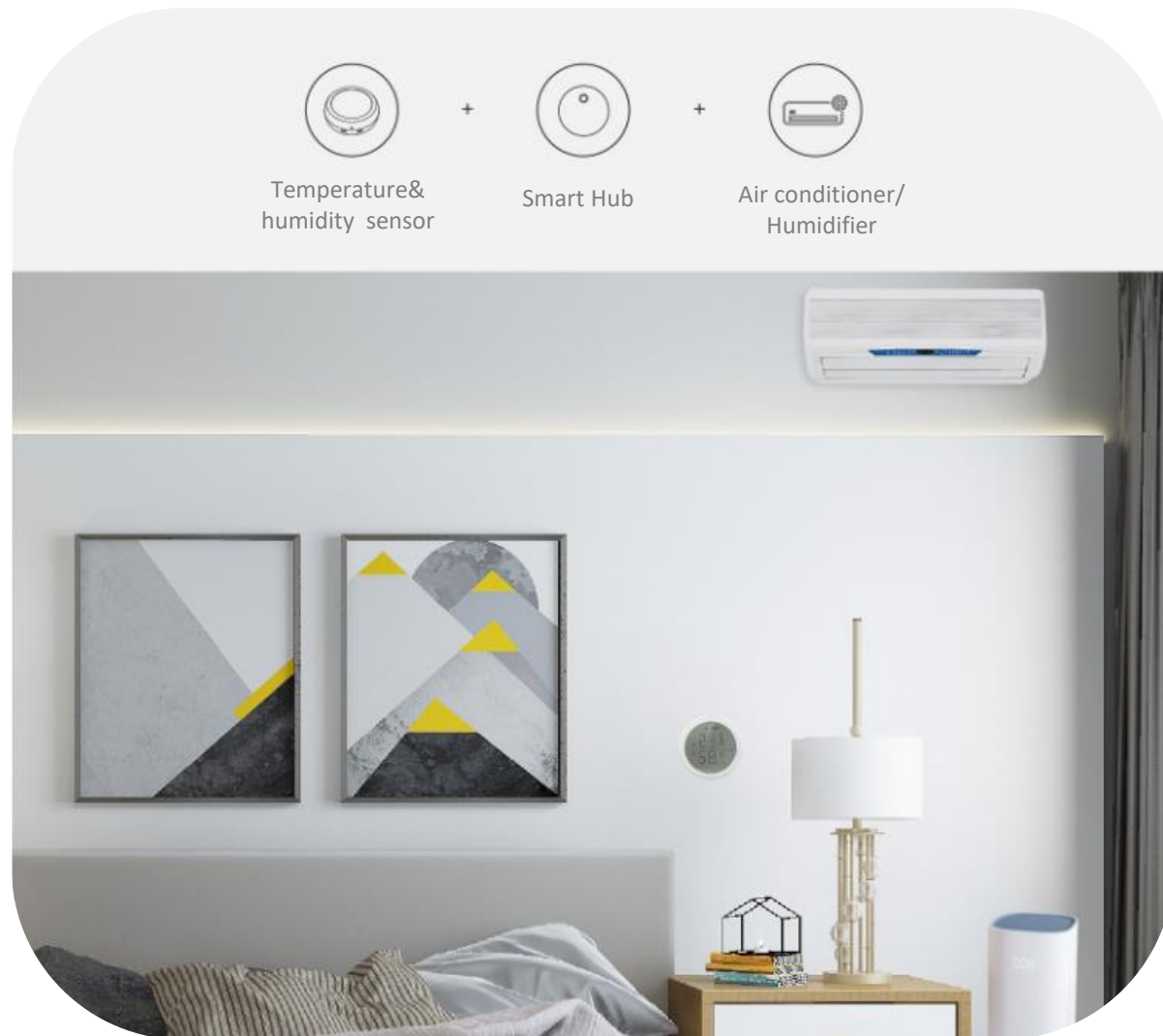

Wireless Technology	ZigBee
Working Voltage	DC 3 V (Two AAA batteries)
Transmission Frequency	2.4 GHz
Working Temperature	-10°C to +55°C 0% to 99.9% RH
Undervoltage Alarm	Supported
Dimensions	φ61.2 mm x 23 mm

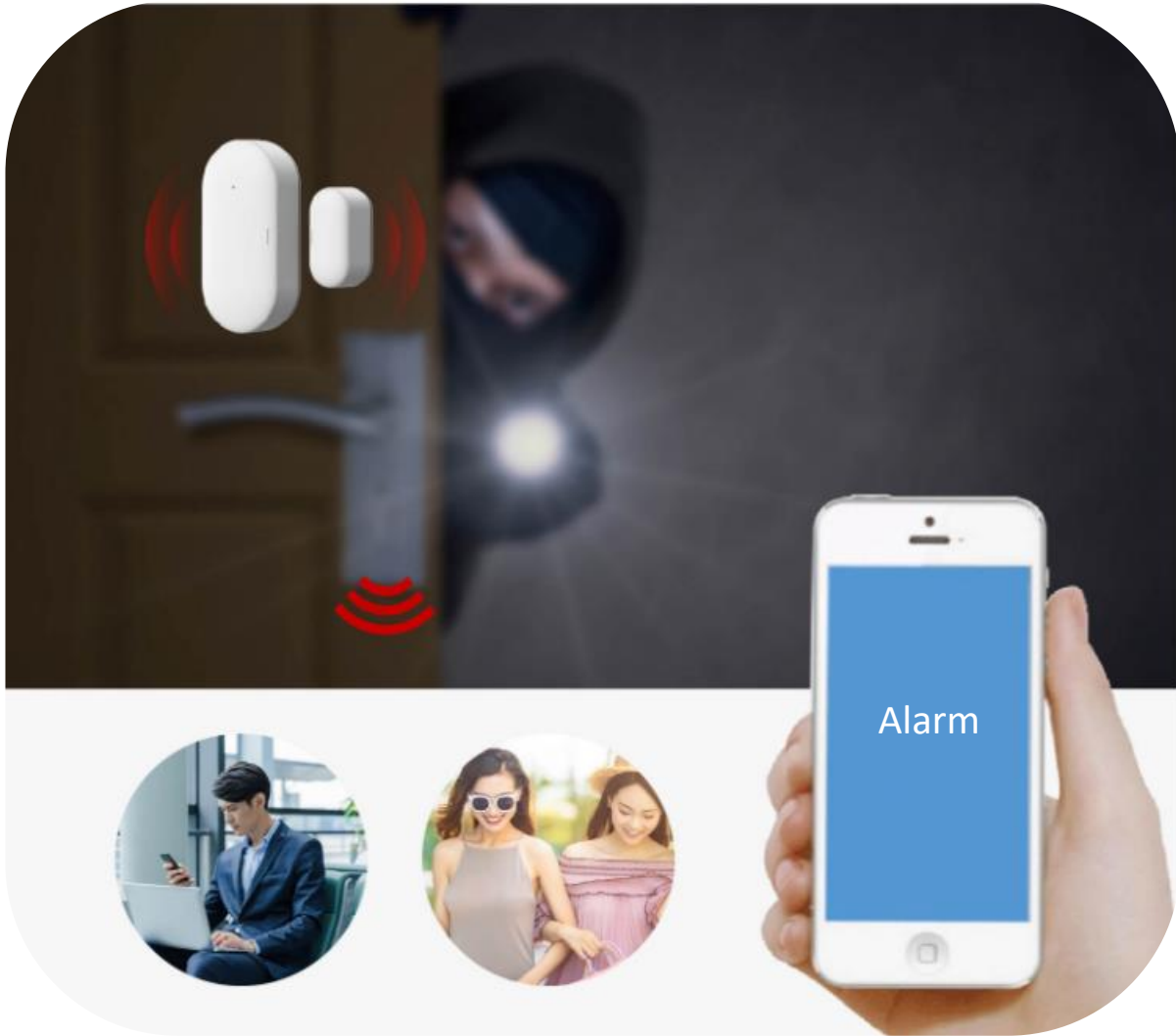

Door and Window Sensor



Sensor

+



Smart Hub

+



Smart socket



Sensor

+



Smart Hub

+



Acousto-optic alarm

Wireless Technology	ZigBee
Working Voltage	DC 3 V (CR2032 battery)
Working Temperature	-10°C to +55°C
Low battery indication	Yes
Alarm Triggering Distance	23±5 mm
Battery Life	More than one year (20 times per day)
Dimensions	Main body: 52.6 mm x 26.5 mm x 13.8 mm Magnet: 25.5 mm x 12.5 mm x 13 mm



Water Leak Sensor



Water Leak Sensor

+

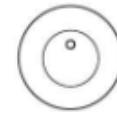

Smart Hub

+



APP



Forgot to turn off the faucet



Aging and rupture of water pipes



Unaware water leakage when leaving home

Wireless technology	Zigbee
Working Voltage	DC 3V(CR2032 battery)
Transmission Frequency	2.4GHz
Working Temperature	0°C to +55°C
Low battery indication	Yes
Battery Life	More than one year (20 times per day)
Detection Method	Water sensor probe
Water proof level	IP66
Dimensions	Φ50 mm x 18 mm



Smart Button



+

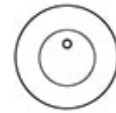

+



Smart Button

Smart Hub

APP

Wireless Technology	ZigBee
Working Voltage	DC 3 V (CR2032 battery)
Transmission Frequency	2.4 GHz
Working Temperature	-10°C to +55°C
Undervoltage Alarm	Supported
Battery Lifespan	More than one year (20 times per day)
Dimensions	Φ50 mm x 16 mm

Smart Hub



Features

- Compact and Lightweight Design
- Standard Zigbee 3.0 Protocol and Bluetooth Sigmesh Standard Protocol
- Support up to 32 Zigbee Sub-Devices
- Customized Scenes & Customized Smart Linkage

Specification

- Power: DC5V / 1A
- Working Temperature: -10°C ~ 55°C
- Networking Method: Wi-Fi
- Zigbee Communication Distance: ≤ 100 m(open area)
- Dimension: 60x60x15mm

05

CURTAIN MOTOR

www.dnake-global.com





PRODUCT OVERVIEW



Zigbee Curtain Motor



Zigbee Roller Shade Motor



Wifi Roller Shade Motor

APPLICATION SCENARIO



OFFICE

Meeting Room
Computer Room
...



HOTEL

Restaurant
Living Room
...



RESIDENTIAL

Bedroom Room
Living Room
...



SYSTEM DIAGRAM

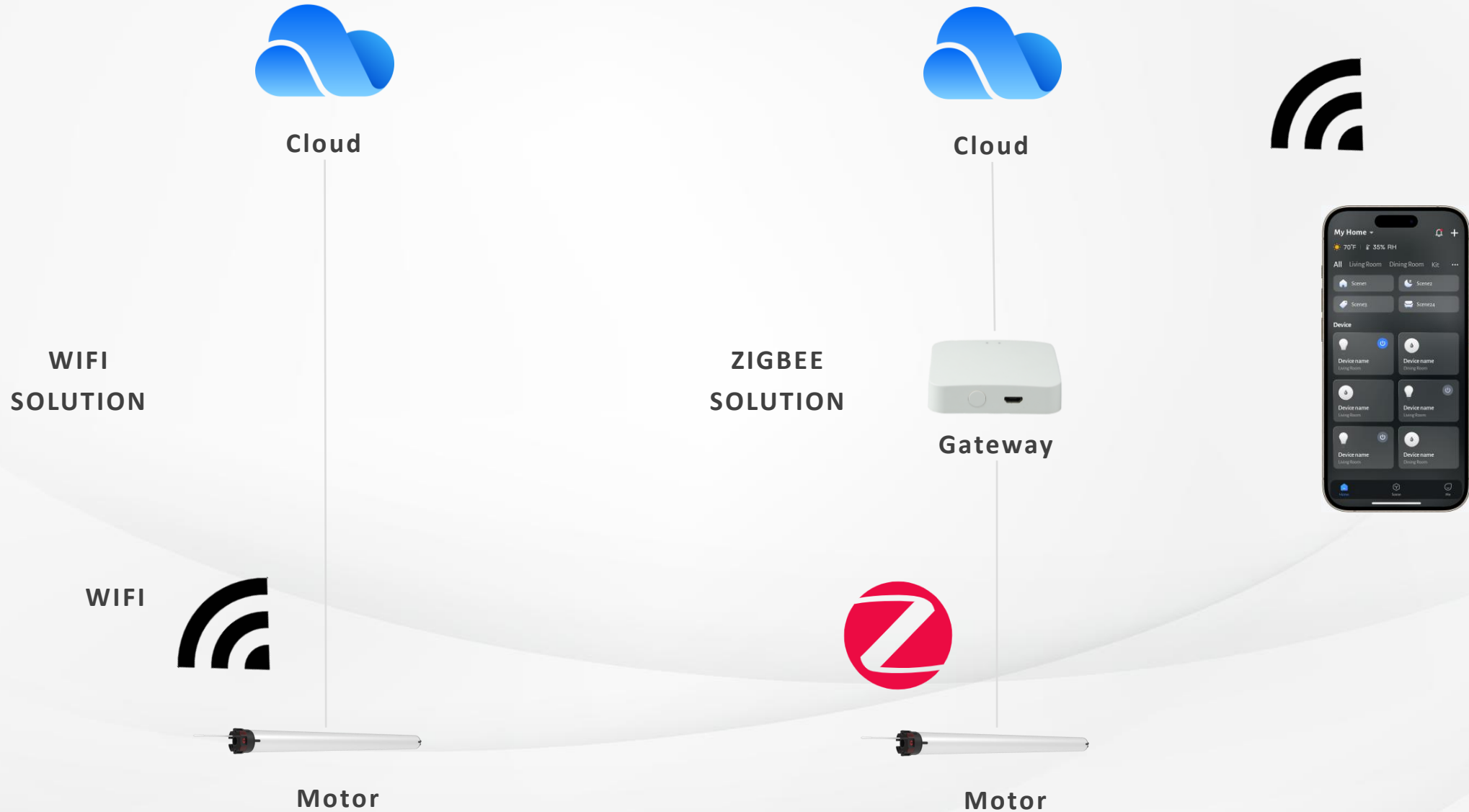

CURTAIN MOTOR

- Use APP to control the open/close/stop of curtains
- Voice control by Alexa
- Timing schedule, open/close as schedule
- Remote control, good for kids and elderly person
- Manual operation to open/close the curtains





ROLLER SHADE MOTOR

- Use APP to control the open/close/stop of tubular
- Voice control by Alexa
- Timing schedule, open & close as schedule
- Remote control, good for kids and elderly person
- Manual operation to open/close the curtains





TECHNICAL PARAMETERS

Items	Curtain Motor	Roller Shade Motor	Roller Shade Motor
Appearance			
Rate Voltage	100-240V	230V	120V
Torque	1.2N.m	8 N.m	8 N.m
Running Time	12min	4min	4min
Connection	Zigbee	Zigbee	Wi-Fi
Pipe diameter	/	35mm	35mm
Certification	CE, RoHS	CE, RoHS	UL
Sales Region	Asia, Europe	Europe	North America



EASY & SMART INTERCOM SOLUTIONS